



KAESER
KOMPRESSOREN®

KAESER KOMPRESSOREN SE
More compressed air with less energy

Overview

1. The company

2. Product portfolio
3. Engineering & Consulting
4. Service
5. The KAESER brand



The company

A family company with an impressive history

1919



Machine workshops
established in Coburg
by **Carl Kaeser Senior**.
Production Spare parts for
machines and vehicles

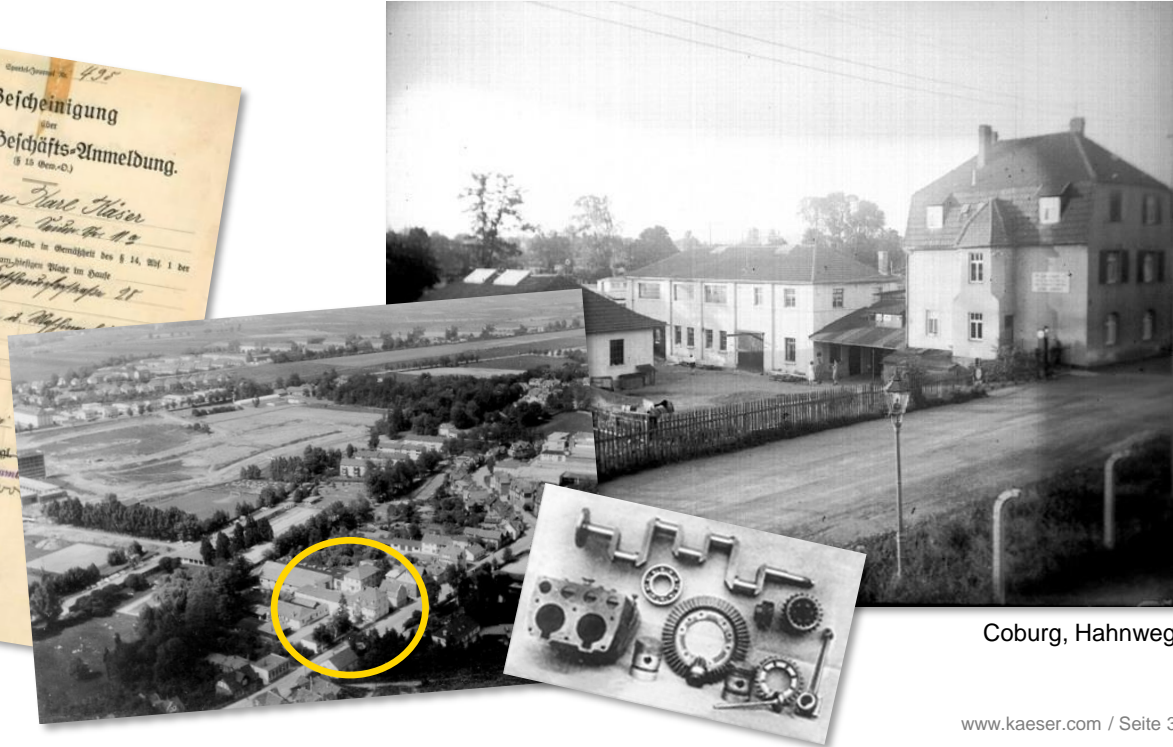

Coburg, Hahnweg

The company

Product timeline



Rotary screw compressors
with SIGMA PROFILE
1975

SIGMA AIR UTILITY

1991



SIGMA AIR MANAGER
master controller
2002

Refrigeration dryers with
latent heat storage
2014



SIGMA AIR MANAGER 4.0
compressed air management
system
2015

Magnetic bearing
turbo compressors
2019



1948
First reciprocating
compressor

1982
MOBILAIR
portable compressors



1993

Rotary lobe blowers and
SECOTEC® refrigeration dryers



2008
Dry-compression rotary
screw compressors



2014
KAESER compressed air filters and
rotary screw blowers with SIGMA
PROFILE

2017
SIGMA SMART AIR



2023
KAESER Measuring
Equipment

The company

In the age of Industry 4.0

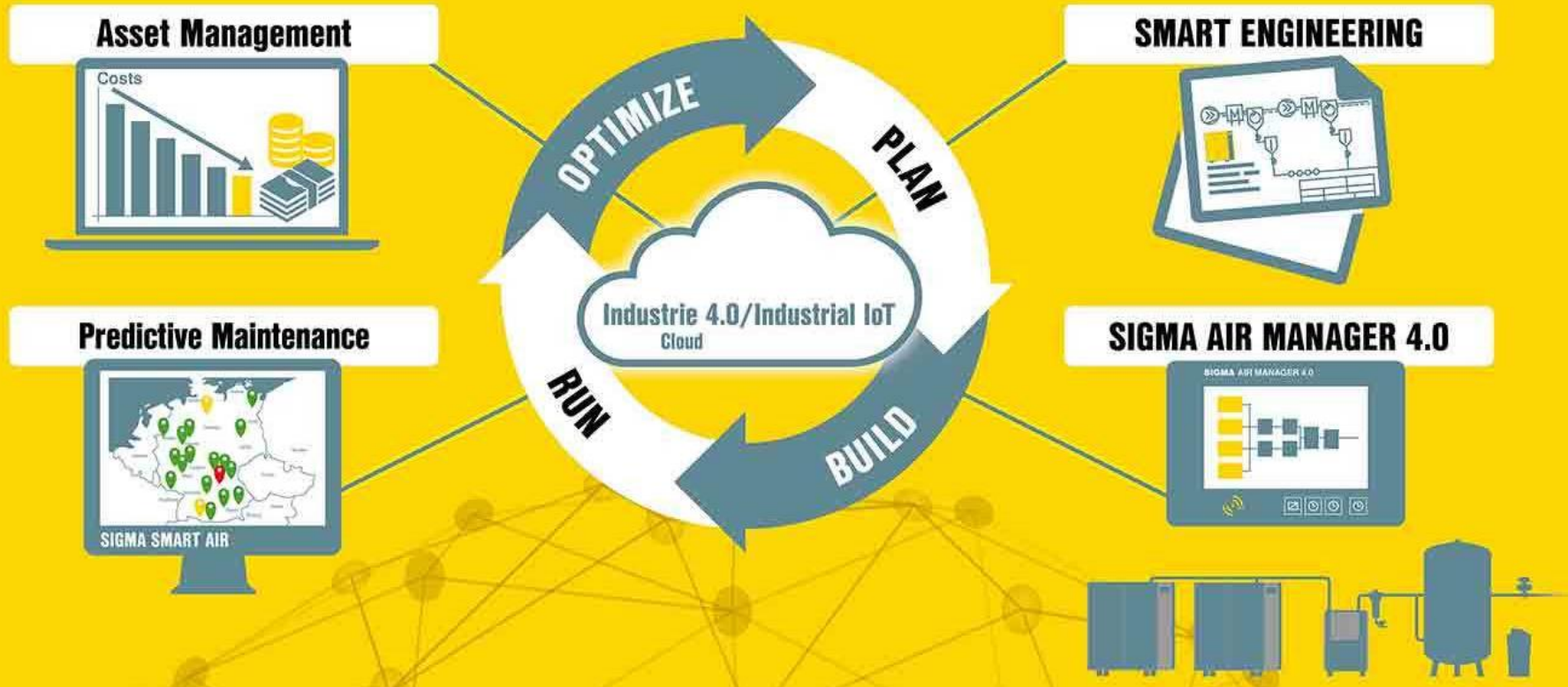

Overview

1. The company
- 2. Product portfolio**
3. Engineering & Consulting
4. Service
5. The KAESER brand



Product portfolio

Excerpt from the current product catalogue



Compressed air for every sector

Product portfolio

SIGMA AIR MANAGER 4.0 compressed air management system (1/2)



SIGMA AIR MANAGER 4.0 - Your key to the world of Industry 4.0

Product portfolio

SIGMA AIR MANAGER 4.0 compressed air management system (2/2)



Realize what's in it

Savings distribution

Sigma Air Manager 4.0 (Test-it) savings/ histogram

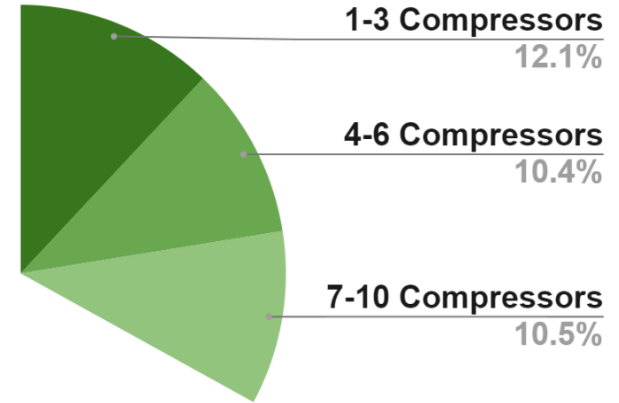
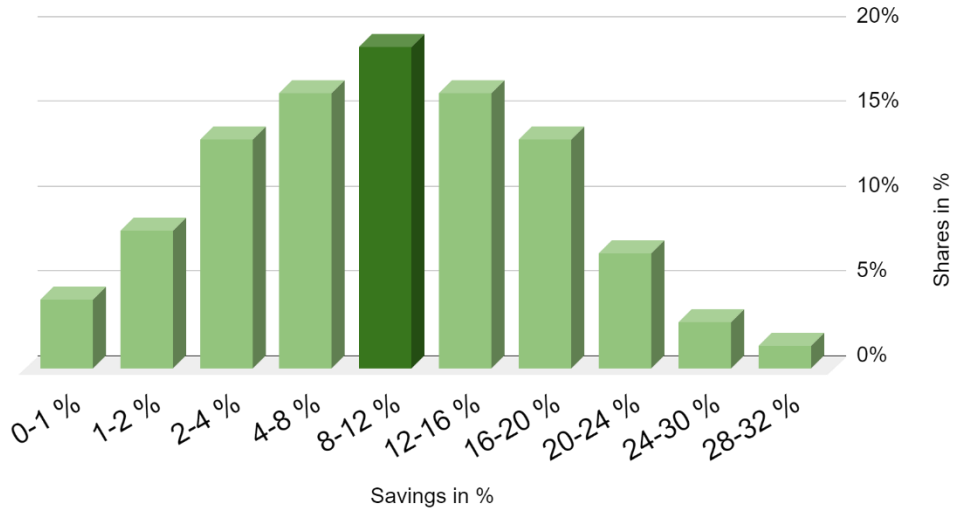

Heat Recovery (1/8)

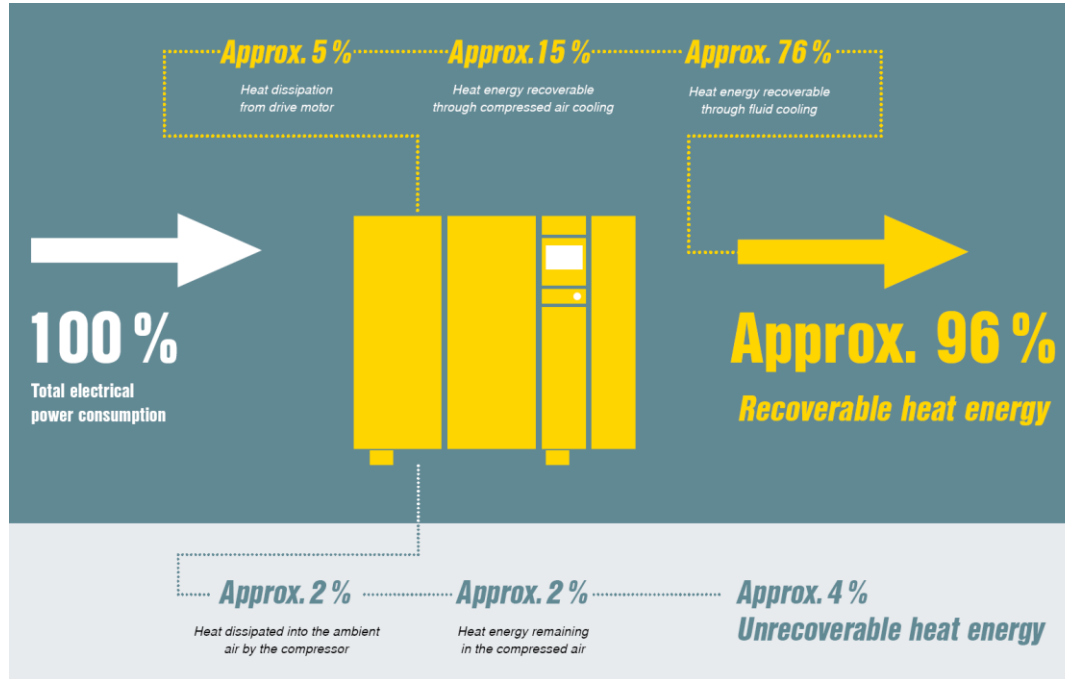

Why heat recovery?

Every rotary screw compressor converts 100% of its input electrical drive energy into heat energy. Up to 96% of that energy can be reused for heating or hot water generation purposes, for example.

Customer benefit:

This not only reduces primary energy consumption, but also significantly improves the applicable company's total energy balance.

Heat Recovery (2/8)

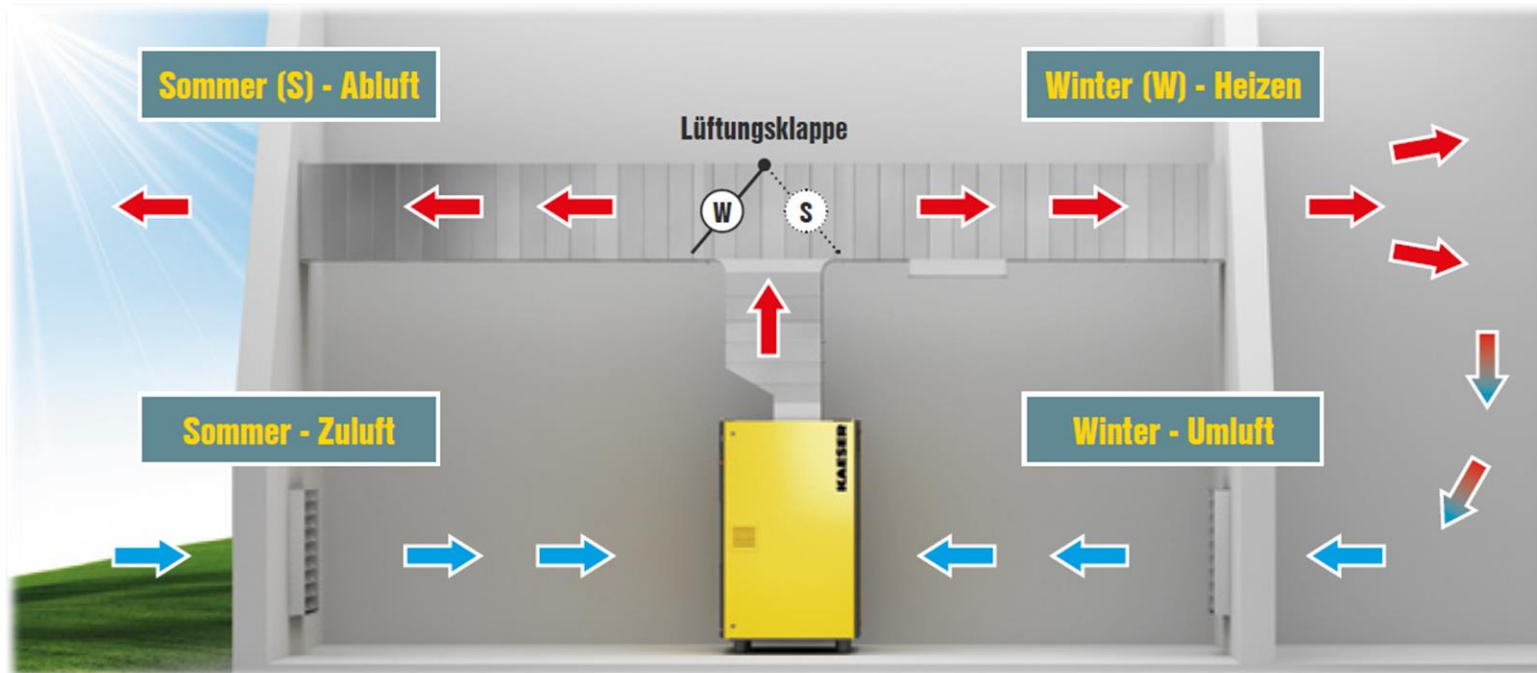

Heat Recovery (3/8)



Heat Recovery (4/8)

bis zu
+70°C
heiß

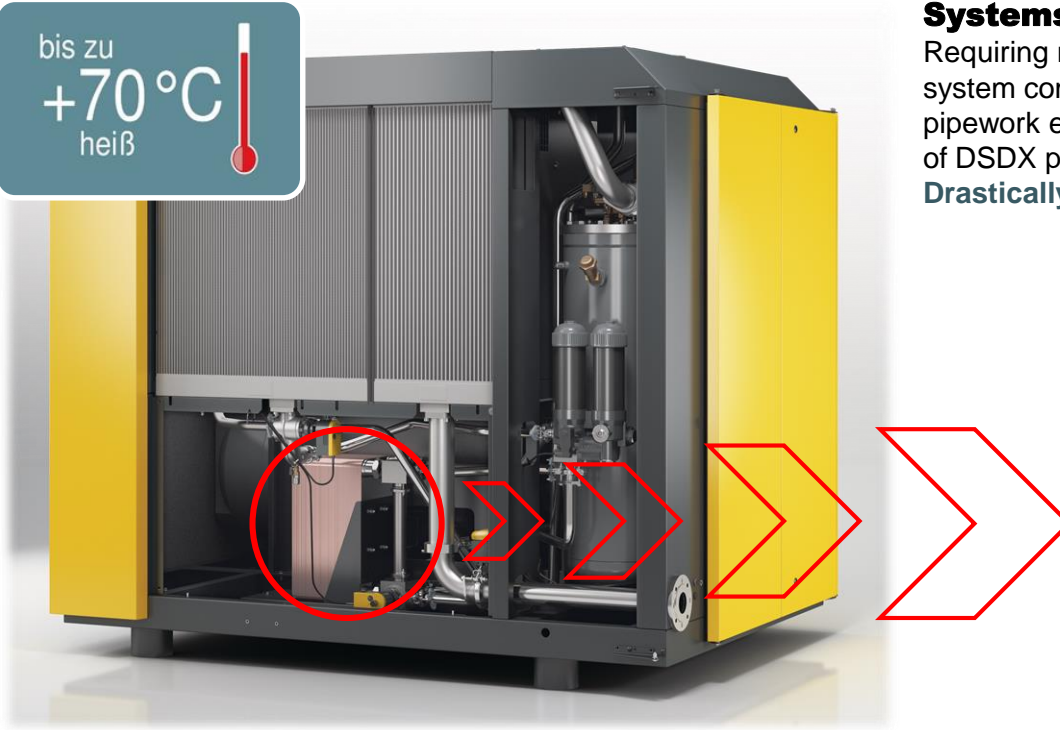

Systems for hot water utilisation

Requiring no additional installation space, a package-integrated system comprising a PWT heat exchanger, ETM and complete pipework enables approx. 71% of the total power consumption of DSDX packages to be recovered for heating water purposes.

Drastically reduces compressed air production costs

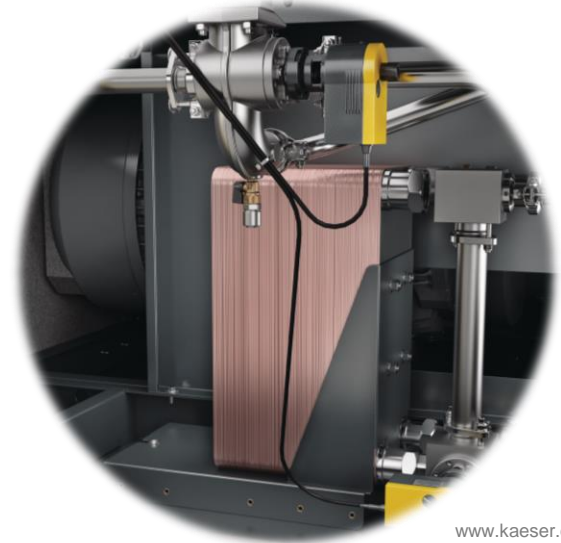

Heat Recovery (5/8)

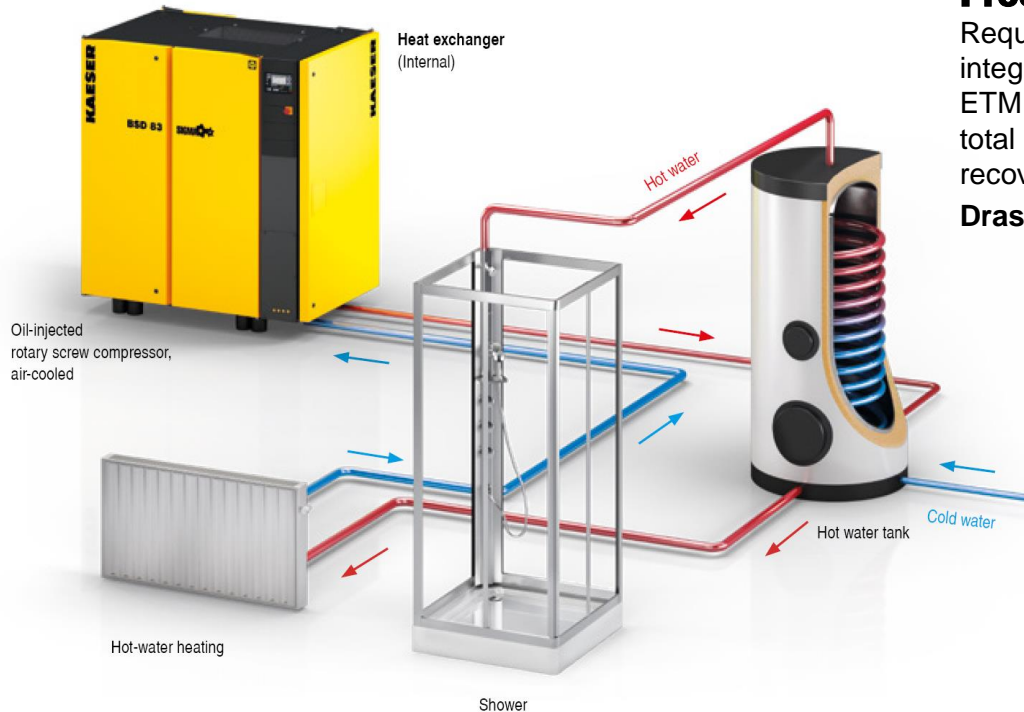

Process, heating and service water

Requiring no additional installation space, a package-integrated system comprising a PWT heat exchanger, ETM and complete pipework enables approx. 71% of the total power consumption of DSDX packages to be recovered for heating water purposes.

Drastically reduces compressed air production costs.

Heat Recovery (6/8)



Heat Recovery (7/8)

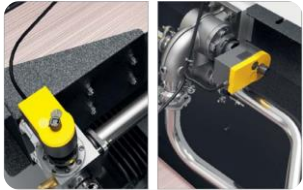

Dual thermal management

Compressor systems with integrated HR have two electromotor-driven temperature control valves (ETM) in the fluid circuit, one each on the HR and the system cooler.



Flexible temperature

The SIGMA CONTROL 2 regulates the compressor temperature as required for optimal use of the Heat Recovery.



Energy savings with SC 2

If all of the heat energy is drawn-off by the heat recovery, the SC2 recognises that cooling is no longer required on the package cooler and, as a result, the fan on the oil cooler is shut off. This achieves additional energy savings.



Winter ON – Summer OFF

If no HR is required in summer, it can be simply deactivated using the SC 2. The system operates under ETM control and immediately switches to operate once again at max. energy efficiency with lowest possible ADT.

Heat Recovery (8/8)



Heat recovery systems for blowers

Application examples for hot water:

- Integration into heating circuits to raise return air temperature
- Integration into heat pump circuits
- Floor heating
- Sludge drying



Application examples for hot air:

- Cooling of process air from blowers, e.g. for bulk materials conveying
- Space heating for production halls

Overview

1. The company
2. Product portfolio
- 3. Engineering & Consulting**
4. Service
5. The KAESER brand



Engineering & Consulting

ADA / KESS

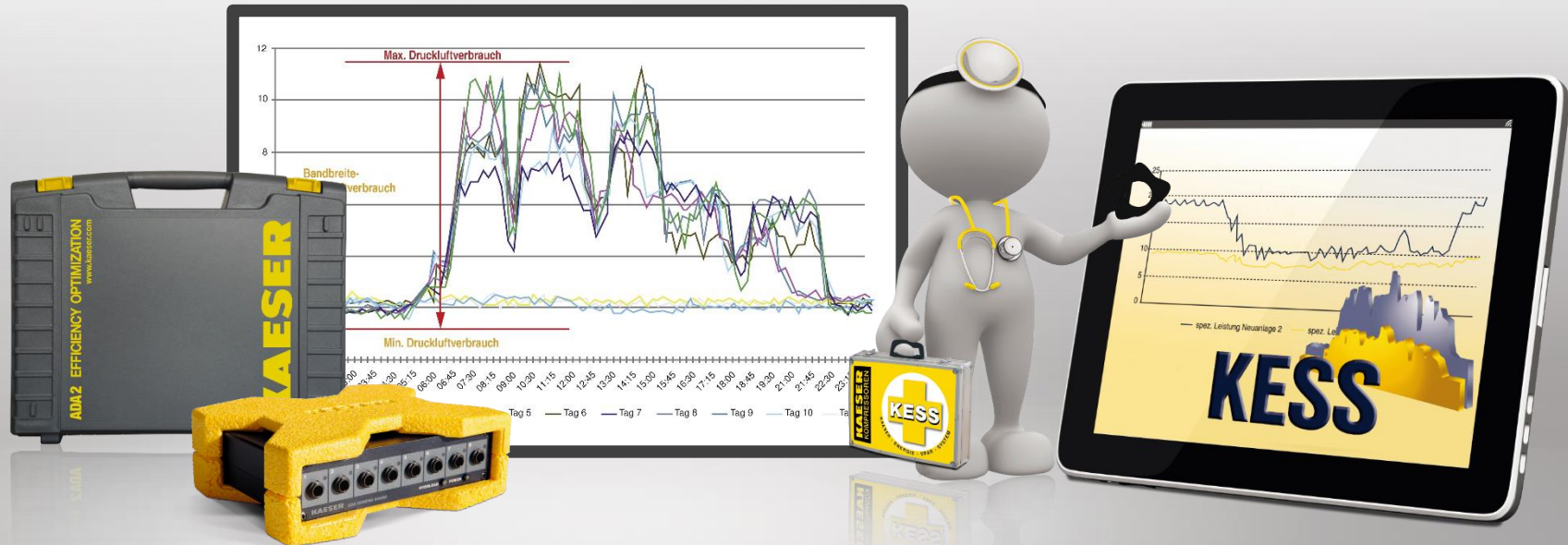

Engineering & Consulting

Engineering / Consulting / Planning

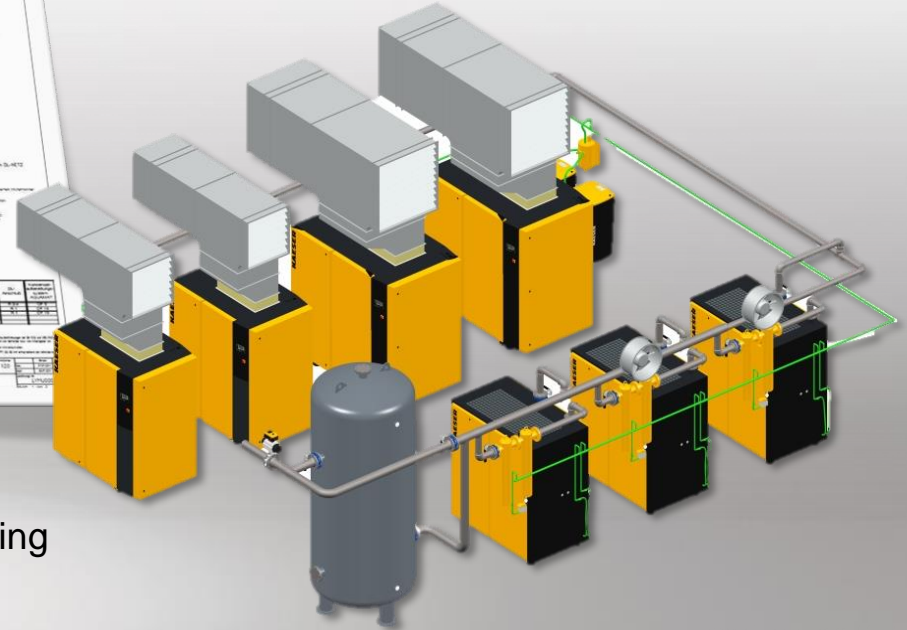
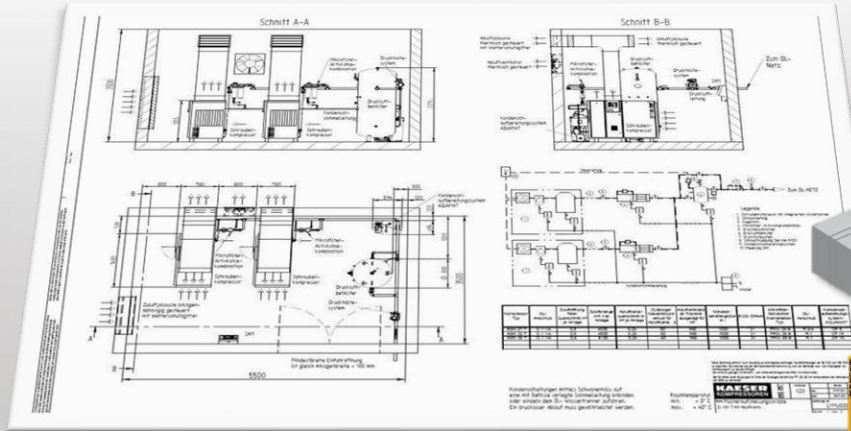

- Computer-assisted general system planning
- 3D station layout for ventilation systems and piping
- Automation systems planning

Übersicht

1. Das Unternehmen
2. Produktportfolio
3. Engineering & Beratung

4. Service

5. Die Marke „KAESER“



Service

Flächendeckend - 24 Std. / 7 Tage die Woche



KAESER Genuine spares and maintenance parts

Overview

1. The company
2. Product portfolio
3. Engineering & Consulting
4. Service

5. The KAESER brand



Summary

Expertise for your compressed air supply

- Decades of experience in compressed air technology:
your one-stop shop
- Bavarian, **family-owned company** with long-term
corporate planning
- **Market leader** in stationary, fluid-cooled
rotary screw compressors (in Germany)
- **Developed** and **produced** in **Germany**
- Exceptionally **high-quality** and **long-lasting** products
- **Energy-efficient** – more compressed air for less
energy
- Extensive service network
(24h service, worldwide)

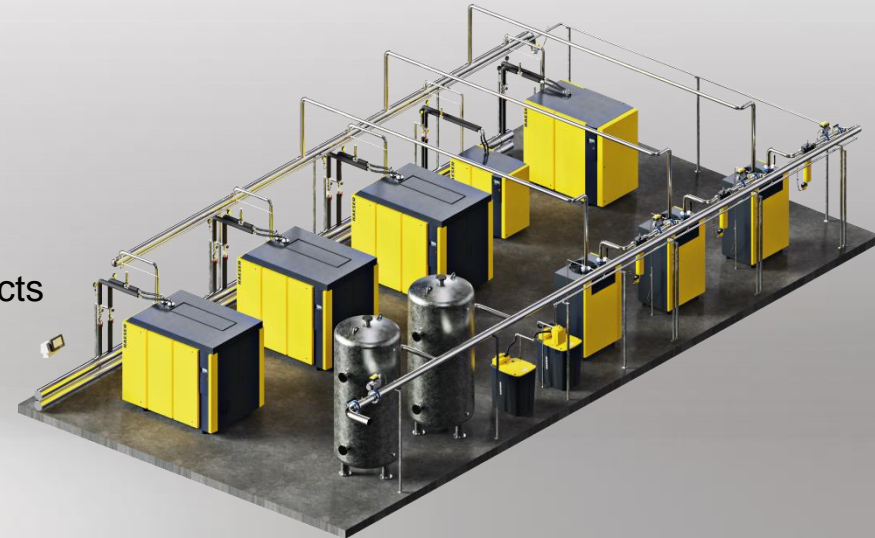



Your partner for
efficient compressed
air systems.

